



Castles

Bishops View Court

ASKING PRICE

£350,000

Church Crescent

Muswell Hill, N10 3NQ

Castles

PROPERTY SUMMARY

Set within the idyllic surroundings of Bishops View Court just off Church Crescent is this one-bedroom ground floor apartment. Conveniently located within a short stroll of the amenities provided on Muswell Hill Broadway. Further comprising kitchen, shower room and reception with direct access to beautifully maintained communal gardens.

Bishops View Court is sheltered housing and has a communal lounge and regular social activities. The block comes with resident management staff and community alarm service and parking is available on a first-come first-serve basis.

Available for those over the age of 55 years.

Lease: 97 years remaining - 125 years from 1/5/1997

Current Service/Maintenance Charge: £2,200 six-monthly

Ground Rent: £279.73 six-monthly





Bishops View Court, N10 Approximate Gross Internal Area = 548 sq ft / 50.9 sq m

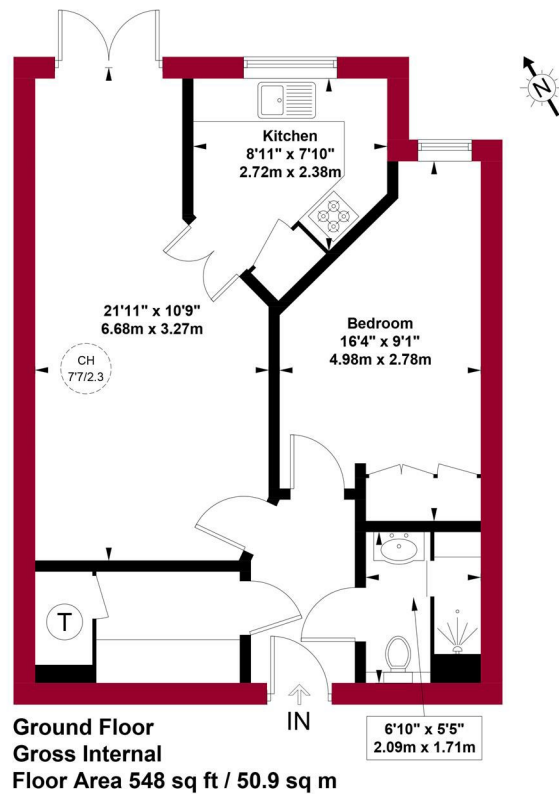

This plan is for layout guidance only and is not drawn to scale unless stated. All dimensions, including windows, doors, and the Total Gross Internal Area (GIA), are approximate. For precise measurements, please consult a qualified architect or surveyor before making any decisions based on this plan.



For a guide to the area
please scan this code for
more information

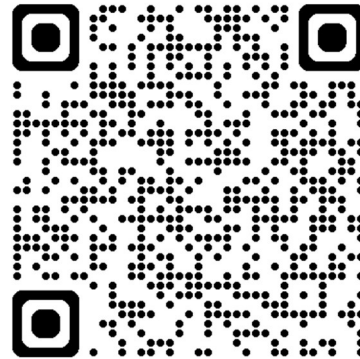

Flat

Leasehold

Council: Haringey

Council Tax Band: D

Agents Note: Whilst every care has been taken to prepare these particulars, they are for guidance purposes only. All measurements are approximate and are for general guidance purposes only and whilst every care has been taken to ensure their accuracy, they should not be relied upon and potential buyers/tenants are advised to recheck the measurements



OFFICE ADDRESS

12 Topsfield Parade
Crouch End
London
N8 8PR

OFFICE DETAILS

020 8348 5515
crouchend@castles.london
<https://www.castles.london>

